

Single Circuit Distribution Block

HM350GR

HMM Series

with polyamide insulating body

- UL94V-0
- 16 mm²
- mounting onto PR/3 type rails according to IEC 60715 Std., "TH/35" type
- available in grey RAL 7042 colour
- can be connected with HMM.2/GR, HMM.2/1+2/GR, HMM.2/2+2/GR, HMS.2/GR, HMFA.2/GR, HMM.4/GR, HMM.4/1+2/GR, HMM.4/2+2/GR, HMM.6/GR

(*) value referred to the terminal and not to the potential distributor

The /GR tag indicates the grey colour version.

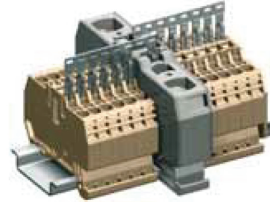
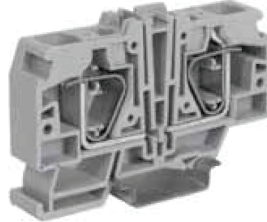
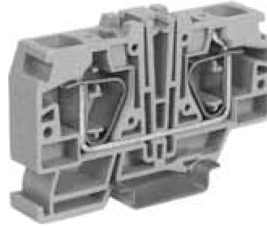

Terminal assembly with double feeding distribution

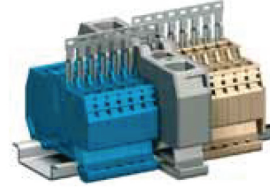

Connection scheme - distribution terminal blocks HMR.16/GR and HMR.16/D/GR

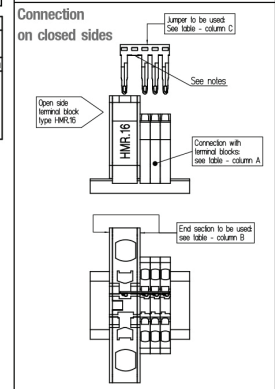
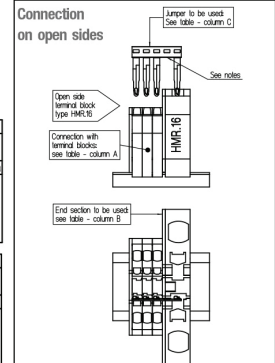
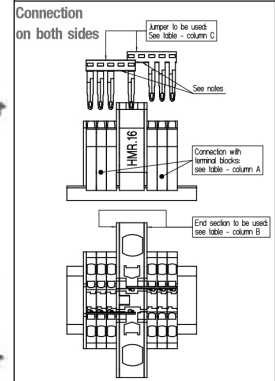

single power supply version	
double supply version	
TECHNICAL CHARACTERISTICS	
function / type	
rated cross-section	(mm ²)
connecting capacity	
flexible	(mm ²)
rigid	(mm ²)
max. flexible with ferrule (mm ²)-ferrule type	
rated voltage / rated current / gauge	conf. to IEC 60947-7-1
rated voltage / rated current / AWG	UL
rated impulse withstand voltage / pollution degree	
insulation stripping length	(mm)
height / width / thickness	TH/35 7,5 mm
height / width / thickness	TH/35 15 mm
height / width / thickness	G32

APPROVALS



ACCESSORIES	
End sections	grey
Permanent cross connection	
Rated current carrying capacity of jumper	(A)
Cross-connection identification strip (100 mm)	green
Multiple common bar	250 mm
Shunting screw and sleeve	
Coloured partition	red, green, white
Cross connection barrier	red
Test plug socket	
Test plug	
Numbering strip	
Screwdriver for the activation of the spring	
Warning plate	on adjacent terminal blocks
Marking tag	printed or blank
End bracket	
Mounting rail according to IEC 60715 Std.	

HMR.16/GR	Cat. No. HM350GR
HMR.16/D/GR	Cat. No. HM360GR

potential distributor
16

1,5 ÷ 25	1,5 ÷ 25
16 - WP160/22	800 V / 76 A (*) / A7
12 KV / 3	
18	
50 / 80 / 12,8	57 / 80 / 12,8

Type	Cat. No.
see table	
see table	
see table	
-	
-	
DFH/4	DH04..
-	
SDD/1	DD001
CCH/4	CCH02
-	
CNU/8/51	NU0851
-	
BTU for PR/DIN and PR/3	BT005
BTO	BT007
BT/3 for PR/3 only	BT003
-	
PR/3/AC of steel	PR003
PR/3/AS same with slots	PR005

cross-connection currents according to UL approval

Colonna A	Colonna B	Colonna C	
Morsello da coll. di rip.	Plastrina terminale da utilizzare	Porte di parallelo utilizzabili	
Sigla	Sigla	Codice	Parziale
HMM.2		PTC03/03 poli	PTC0303
HMM.2/1+2		PTC03/05 poli	PTC0305
HMM.2/2+2	HMR.16-2PT/GR	PTC03/10 poli	PTC0310
HMS.2		PTC03/00 (47 poli)	PTC0300
HMFA.2			

Colonna A	Colonna B	Colonna C	
Morsello da coll. di rip.	Plastrina terminale da utilizzare	Porte di parallelo utilizzabili	
Sigla	Sigla	Codice	Parziale
HMM.4		PTC05/03 poli	PTC0503
HMM.4/1+2		PTC05/05 poli	PTC0505
HMM.4/2+2	HMR.16-4PT/GR	PTC05/10 poli	PTC0510
		PTC05/00 (40 poli)	PTC0500

Colonna A	Colonna B	Colonna C	
Morsello da coll. di rip.	Plastrina terminale da utilizzare	Porte di parallelo utilizzabili	
Sigla	Sigla	Codice	Parziale
HMM.6		PTC08/03 poli	PTC0803
		PTC08/05 poli	PTC0805
		PTC08/10 poli	PTC0810
		PTC08/00 (30 poli)	PTC0800

ANNOTAZIONE:

Il N° di poli da utilizzare sarà uguale al numero di morsetti da collegare compreso il ripartitore + 1

Per permettere il collegamento al morsetto ripartire eliminare sempre il secondo pin dalla striscia del ponte PTC.



Terminal block connected to supply terminal	End sections		Permanent cross connection (**)		
	Type	Cat. No.	Type	Cat. No.	Total capacity
HMM.2/GR	HMR.16-2PT/GR	HM352GR	PTC/03/03 poles	PTC0303	24 A
HMM.2/1+2/GR			PTC/03/05 poles	PTC0305	
HMM.2/2+2/GR			PTC/03/10 poles	PTC0310	
HMS.2/GR			PTC/03/00 (47 poles)	PTC0300	
HMFA.2/GR					
HMM.4/GR	HMR.16-4PT/GR	HM354GR	PTC/05/03 poles	PTC0503	32 A
HMM.4/1+2/GR			PTC/05/05 poles	PTC0505	
HMM.4/2+2/GR			PTC/05/10 poles	PTC0510	
			PTC/05/00 (40 poles)	PTC0500	
HMM.6/GR	HMR.16-6PT/GR	HM356GR	PTC/08/03 poles	PTC0803	41 A
			PTC/08/05 poles	PTC0805	
			PTC/08/10 poles	PTC0810	
			PTC/08/00 (30 poles)	PTC0800	

(**) In order to enable the connection to the supply terminal the second pin must be always removed from the strip of the PTC jumper.